

Tp of Antrim and Inland

State Land Office, Lansing, Oct 10th 1889

Township 27⁺²⁶ North, Range 13 Mich.

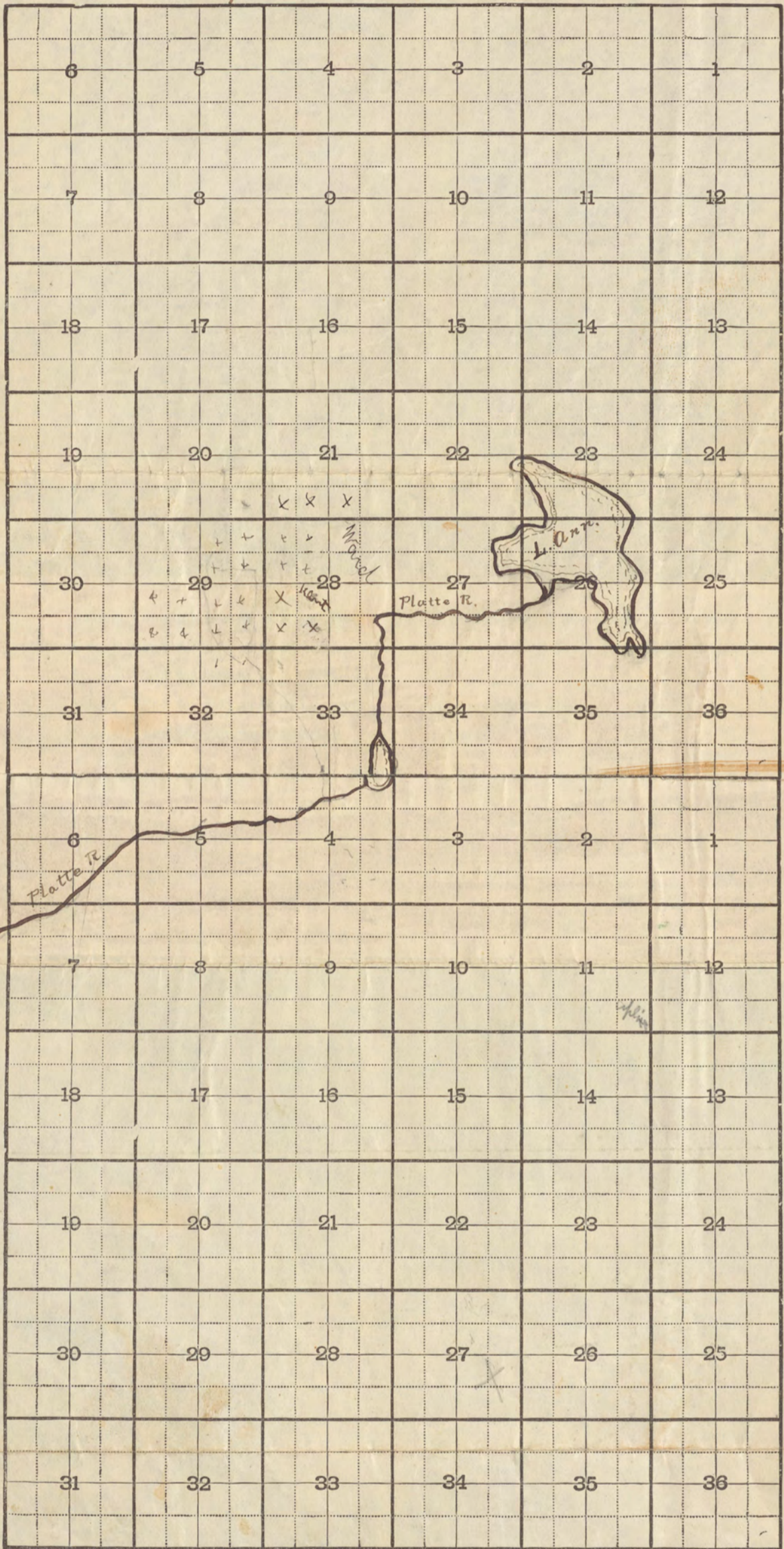

INGLIS BROS. & EVERARD, PRINTERS, KALAMAZOO.

- _____ Swamp Land for sale at \$1.25 per acre.
- _____ Swamp Land for sale at \$2.00 per acre.
- _____ Swamp Land for sale at \$ _____ per acre.
- _____ School Land for sale at \$4.00 per acre.
- _____ College Land for sale at price marked _____ on plat.

To be offered at public auction at the Auditor General's Office at Lansing on the second Thursday in _____ 188 _____ at a minimum price of _____ per acre.